

User Manual EN

Smart Outdoor Spotlight | CW SL01



READ THIS FIRST | SAVE THESE INSTRUCTIONS

support@yeismooi.com(reply within 24 hours)

Product Information

- Model: CW SL01

· Voltage: 12V

· Wattage: 10W

· Color Temp: 2200-4000K

· Brightness: 850 lm

· Light Source: LED
- Thread: IEEE 802.15.4 @ 2.4GHz

· IP Rating: IP67

· Operating Temperature Range: -20°C to 45°C

· Box Content: 1 LED Spotlight, 1 Stake, 1 User Manual

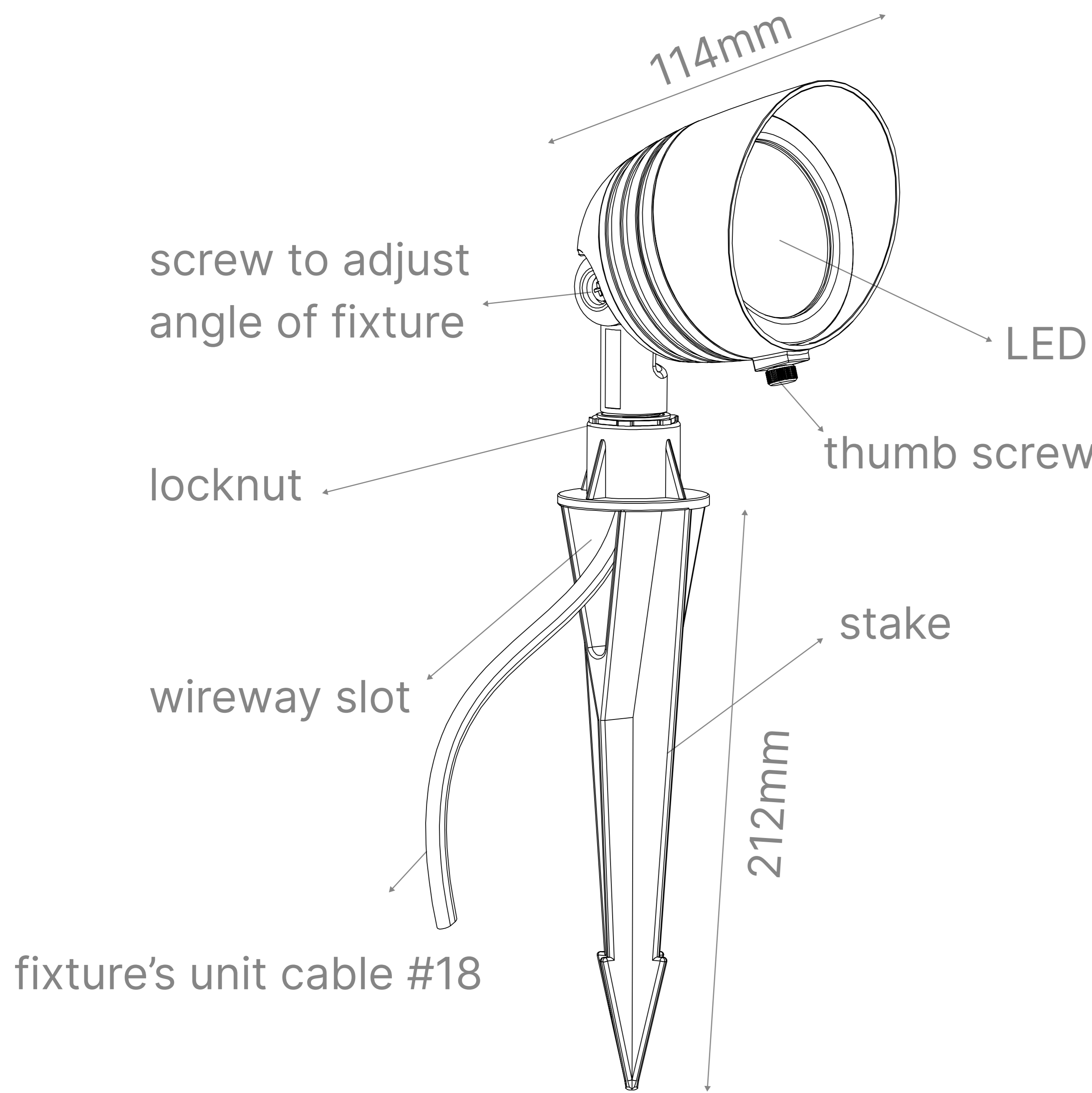

Preparation before Installation

Before installing the spotlights, the following items need to be prepared. **These items are not included in the package and need to be purchased separately.**

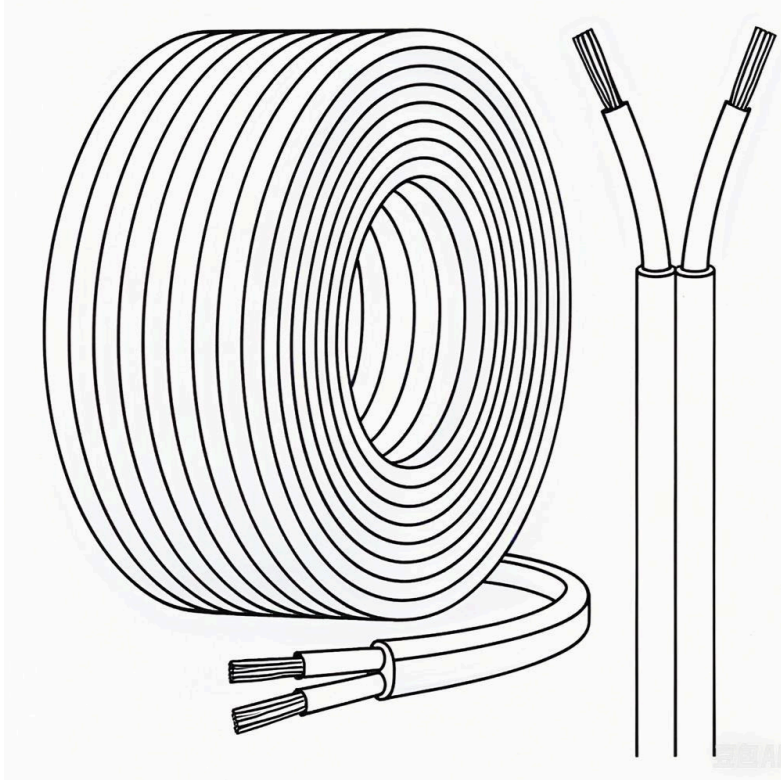

- Main cable
- Connect the fixture to a main cable rated for outdoor use, SPT-3 type, with a minimum temperature rating of 60°C. Choose the wire gauge based on the longest distance from fixture to the transformer:
- 8 GA: up to 250 ft (76 m)
 - 10 GA: up to 150 ft (45 m)
 - 12 GA: up to 100 ft (30 m)

Preparation before Installation

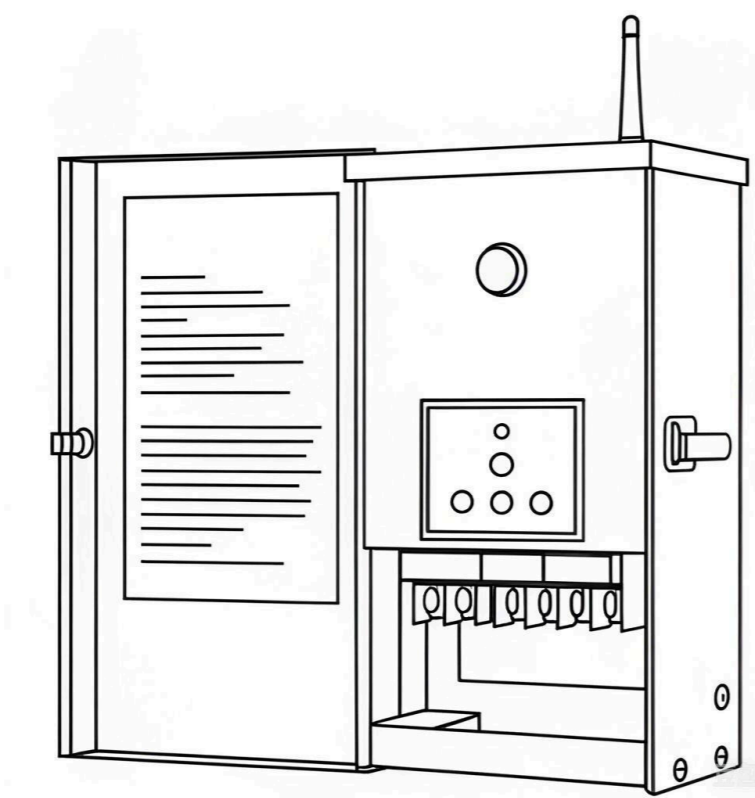

- Transformer
- This fixture is to be used only with a transformer rated a maximum of 300W (25 AMPS) 15 volts.

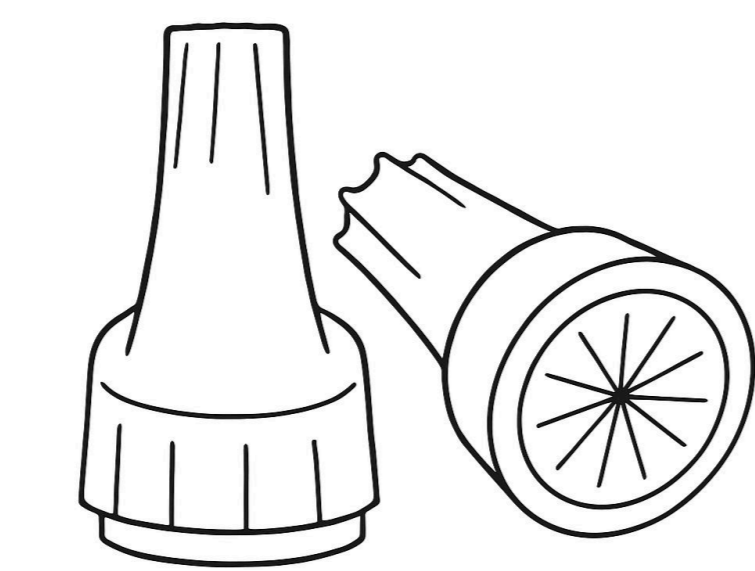

- Wire connector
- Two wire connectors for a fixture.
 - Outdoor gel-filled wire connectors, 600V Max. 20-10 AWG,

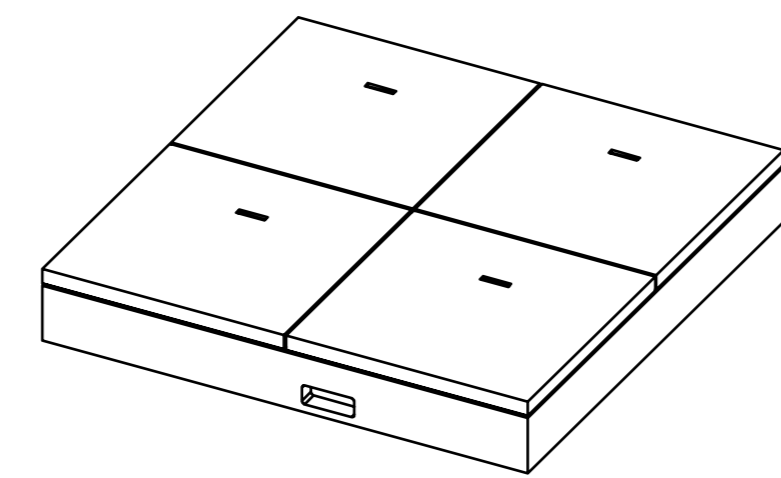

- Yeismooi smart switch hub
- To setup and control the spotlights, you'll need a Yeismooi smart switch hub.

Installation Guide

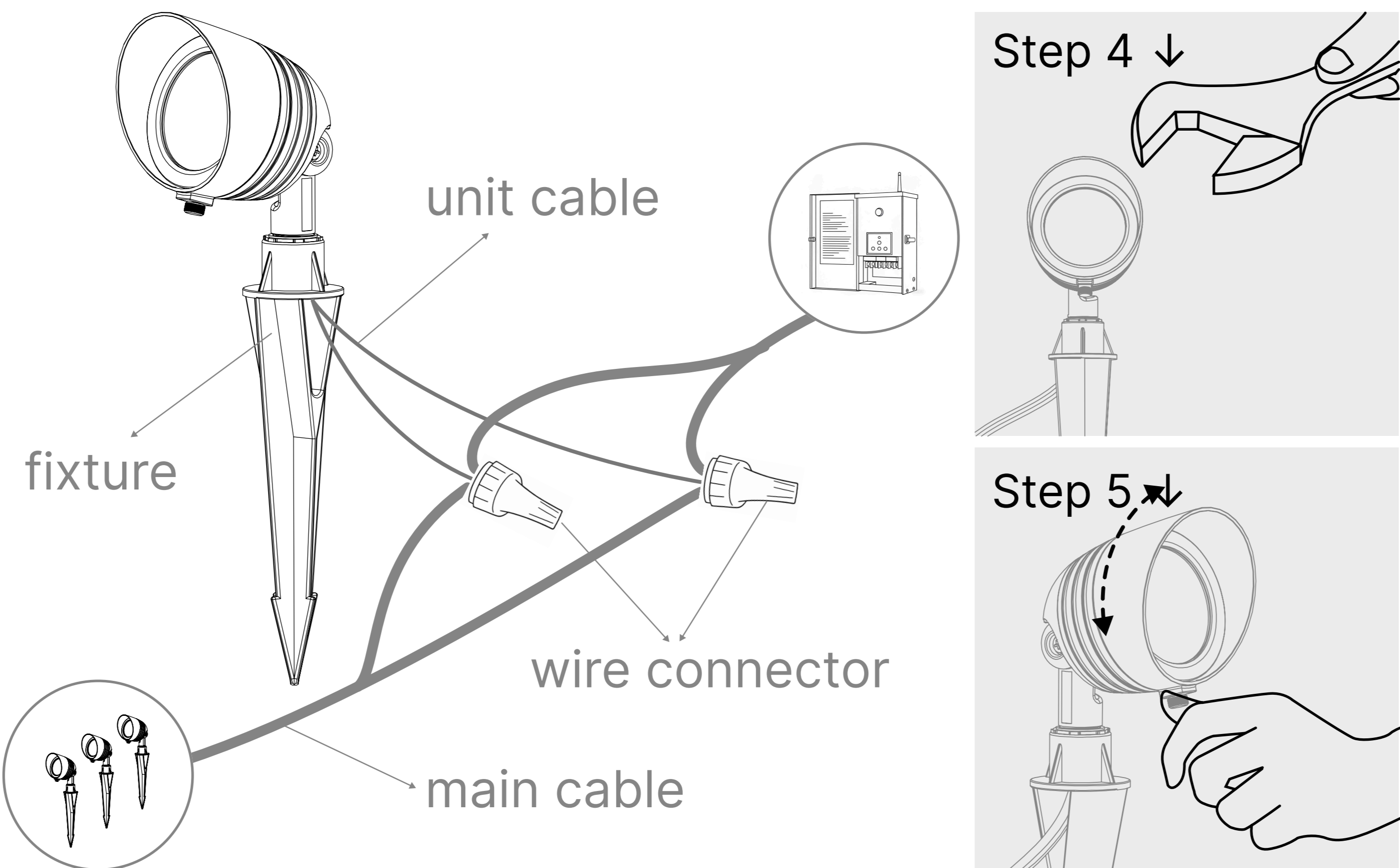

- Determine desired location for mounting fixture.
- At desired location, hammer stake into ground. To avoid damage to stake, place a board on top of stake while hammering. If ground is hard and stake is difficult to install, make a crosscut in ground using a flat shovel.
- Clear away area in ground at wireway slot in top of stake.
- Lay unit cable into wireway slot and screw fixture into stake. Aim fixture in desired direction and secure by tightening locknut. If necessary, use wrench or pliers for final tightening of nut.
- Adjust angle of accent light by loosening thumb screw.
- TURN OFF POWER.**
- Attach fixture's unit cable to main cable with wire connectors.

Safety Instruction

- This fixture is intended for installation in accordance with the National Electrical Code and local code specifications. Failure to adhere to these codes and instructions may result in serious injury and/or damage to the PSU and void the warranty.
- ▲WARNING:** Risk of Electric Shock. This fixture is not to be installed within 10 feet (3m) of a pool, spa or fountain.
- The fixture's unit cable shall be protected by routing in close proximity to the luminaire or fitting, or next to a building structure such as a house or deck;
- The fixture's unit cable can not be buried except for a maximum 6 inches (15.2 cm) in order to connect to the main low voltage cable; and have the length cut off so that it is connected to a connector within 6 inches (15.2 cm) from a building structure, a luminaire, or fitting.
- The main cable is intended for shallow burial, with a depth of less than 6 inches (152 mm).
- Wiring connections must be made with approved/listed wire connection device(s) suitable for the application. Do not exceed manufacturers' wiring combination specifications for size and quantity of conductors.

Caution

When installing this lighting (low voltage), care should be taken to keep clear of potentially combustible materials. When maintaining the fixtures, be sure to remove leaves, pine needles, grass clippings, mulch, or any debris that has accumulated on the light bulb, lens, or body of the fixture.

Setup Guide for Smart Features

- Preparation:** To enjoy smart features of the spotlights, you'll need a Yeismooi smart switch hub. Ensure your switch hub is plugged in, connected to Wi-Fi, and added to the Yeismooi App (App Store/Google Play) in advance.
- App Setup:** Connect your phone to the same Wi-Fi as the switch hub.
- Enter Pairing Mode:** Turn on the lights' power after installing all. If this is the first time powering it on, the spotlight will automatically enter pairing mode (flashing in a breathing pattern). If not, manually activate pairing mode by following the instructions in the "Pairing Mode" section of the manual.
- Pair the Device** in the Yeismooi App: Open the Yeismooi App, tap the "+" icon in the top-right corner, and select "Add Device". Follow on-screen instructions to set up spotlights individually.

- Notes: Pairing Mode**
- Automatically enters pairing mode on first power-up.
 - Turn the spotlight on and off 5 times, keeping it on for 2 seconds each time before turning it off.

- Or delete the device on the Yeismooi App while it's online.
- The pairing mode will last 2 hours and the light will be flashing in a breathing pattern.

Setup Guide for Smart Features

Control via Third-party Voice Assistants

You can also use third-party voice assistants (e.g. Alexa & Google home) to control Yeismooi devices & scenes. The control capabilities of devices and scenes depend on the platforms, such as device control and scenes. For detailed steps on setting up, please open the Yeismooi app and go to the "Me" and find Third-party Voice Assistant section for full instructions. It includes step-by-step, illustrated instructions to help you easily enable the skill, sync devices and lighting scenes ("Relax Time," "Party Night," etc.), and control them hands-free with third-party voice assistant. (e.g., "Alexa, turn on Relax Time")

Warranty, Return & Refund Policy

Yeismooi products come with a one-year warranty, starting from the date of purchase. For detailed warranty, return and refund policy, please refer to our official website www.yeismooi.com. **You are always welcome to contact us by sending an email at support@yeismooi.com(reply within 24 hours)**

www.yeismooi.com

support@yeismooi.com



Frequently Asked Questions